

MARI-CHA II

CNB





Top left:
Main salon lounging
area viewed from
port.



Top right:
Two double guest's
cabin and owner's
state room.



Bottom left:
Main salon dining
table set for
6 privileged
(on port-board).



Bottom right:
Opposite view of
owner's state room.





Top: The chart table. Top right: Crew salon (galley at background). Right: The Galley.

Drawing below:

1 Chart table	6 Main salon lounging area
2 Skipper's cabin	7 Galley
3 Owner's cabin	8 Guest cabin
4 Guest cabin	9 Crew salon
5 Main salon dining table	10 Crew quarters

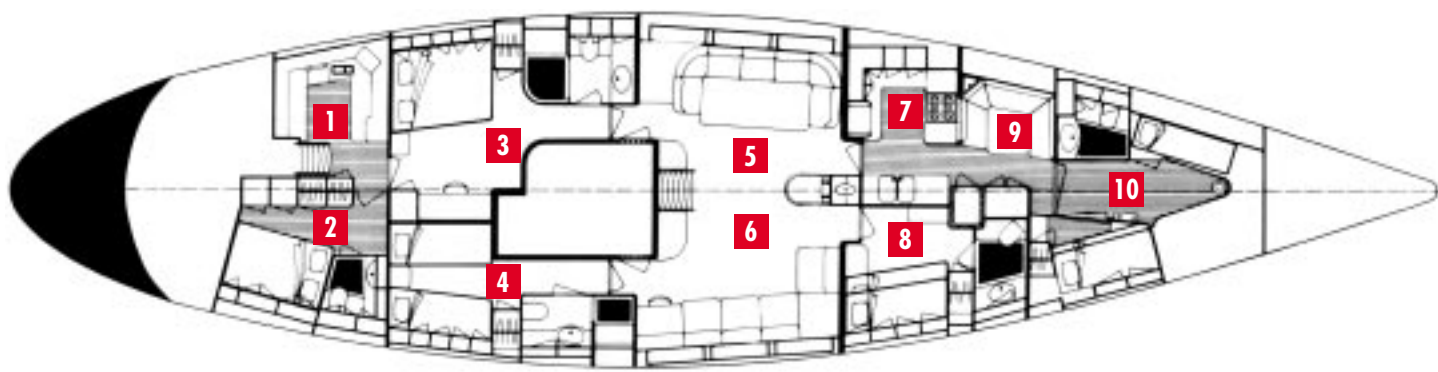

Designed by François Catroux of Paris, the joinery of the *Mari-Cha II* has been built out of light weight Nomex panels veneered.

MAIN SALON
air conditioned, a dinner table that can seat up to ten people, a lounging

area with built-in bar fridge, a HI-FI stereo system with CD player, a multi-standard colour TV and VCR.

TWO GUESTS CABINS
twin berths, private ensuite bathrooms with shower.

OWNER'S STATEROOM
a queen-size bed, a

desk/boudoir, a private ensuite bathroom with shower.

SKIPPER'S CABIN
queen-size bed, private ensuite bathroom and shower.

CREW'S QUARTERS
twin berths, a private ensuite bathroom with shower.

All cabins have radio-cassette players, are fully air-conditioned, have roller blinds and mosquito screens over the opening hatches.

FULLY EQUIPPED GALLEY
fridge : 20 ft³, freezer: 20 ft³, microwave oven, washer/dryer, 4 burners gaz range plus 2 ceramic Gaggenau, etc.

A PRINCESS OF THE SEA

With Mari-Cha II, the designer German Frers has achieved the perfect match between two families: that of luxury yachts, and that of racing thoroughbreds. As a streamlined racer, the distinguished feature of Mari-Cha II is its migratory temperament. Its inaugural crossing is proof enough: from Bordeaux across the North Atlantic in 14 days, not forgetting the outstanding cruise that took her around the world. Although a thoroughbred racer, Mari-Cha II is the ultimate in comfort. Whether it be the deck fittings, the navigation instruments, or her interior fittings, she is fully equipped, for her owner's pride and pleasure.

Builder	CNBB	Beam	21'08"	Fuel capacity	925 gal.
Year of construction	1989	Displacement	11,060 lbs	Main engine	Caterpillar 280 HP
Architect	German Frers	Displacement	128,000 lbs	Generators	Northern Light 30 Kw
Interior design	Francois Catroux	Sail area	58,000 sq. ft.	Generators	Northern Light 8 Kw
Hull construction	Aluminum	Sail area	4,900/6,995 sq. ft.	Bowthruster	Richfield 30 HP
L.O.A.	92'10"	Fresh water	1,125 gal.	Air conditioning	Condaria 2 x 3 HP

CNB